



NOTICE OF PUBLIC HEARING BEFORE THE BLAINE PLANNING COMMISSION

PLEASE TAKE NOTICE that the Planning Commission of the City of Blaine, Minnesota, will hold a public hearing on the following application:

CASE: 19-0025

APPLICANT: The Goddard School

LOCATION: 12612 and 12608 Central Avenue NE

PETITION: The applicant, the Goddard School, is requesting a conditional use permit to allow for the construction of a 10,060 square foot day care/early education center. This center will be directly south of the Emberwood Apartments.

Subject parcel is more particularly described as:

LOT 37, BLOCK 2, HONEY GROVE, ANOKA COUNTY, MINNESOTA

AND

THAT PART OF THE SOUTHEAST 1/4 OF THE SOUTHWEST 1/4 OF SECTION 5, TOWNSHIP 31, RANGE 23, DESCRIBED AS FOLLOWS: BEG AT A PT ON E LINE OF SD 1/4 1/4 482 FT S OF NE COR THEREOF, TH W PRL/W N LINE OF SD 1/4 1/4 435 FT, TH S PRL/W SD E LINE 100 FT, TH E PRL/W SD N LINE TO SD E LINE, TH N ALG SD E LINE TO POB, EX RD, SUBJ TO EASE OF REC

HEARING DATE AND TIME: Said hearing will take place on **Tuesday, June 11, 2019**, at the Blaine City Hall Council Chambers, located at 10801 Town Square Drive, Blaine, Minnesota, 55449 at 7:00 p.m.

All interested persons are invited to attend and be heard. If you cannot attend, please mail your comments in. Persons who have questions may call the Planning Department, City of Blaine, at (763) 785-6180.

Hearing impaired persons planning to attend who need an interpreter or other persons with disabilities who require auxiliary aids should contact Pat Robinson at (763) 785-6180 no later than June 5, 2019.

Catherine Sorensen, City Clerk

Dated: May 28, 2019

Published in the Blaine-Spring Lake Park "Life" May 31, 2019

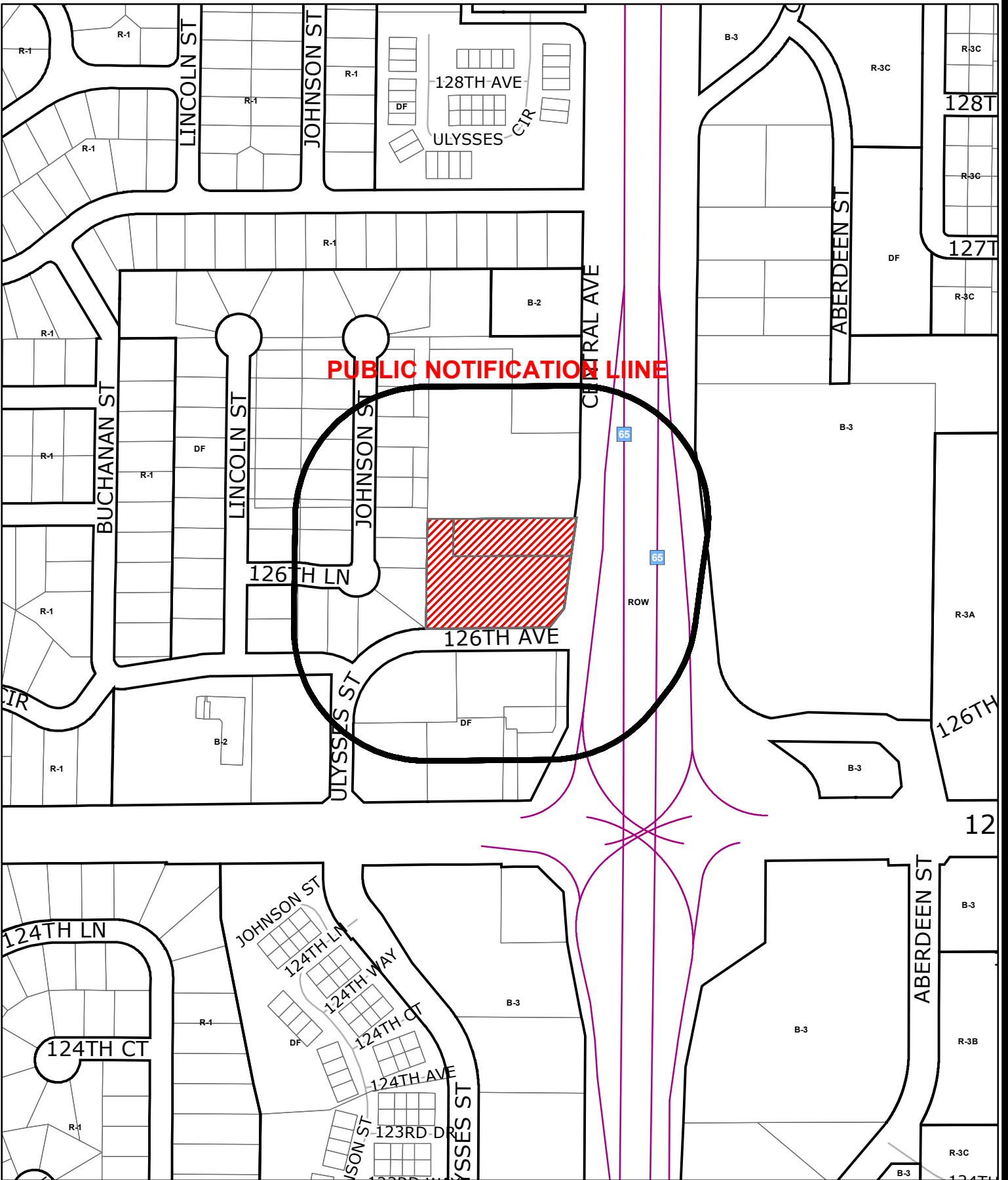

Case File No. 19-0025
The Goddard School

Blaine Planning Department / 10801 Town Square Dr NE / Blaine, MN 55449 / (763) 785-6180

